

CRUISING HIGHLIGHT AREAS

- Amazon
- Baltic Sea / Russia
- Black Sea
- Canary Islands
- Caribbean
- Central America
- Great Britain / Ireland
- Greenland / Iceland
- Mediterranean
- Middle East
- North America
- Norway / Norwegian Fjords
- Panama Canal
- Red Sea / Egypt
- South America
- TransAtlantic
- Western Europe



5-Star MS Deutschland

The 5-Star MS Deutschland sets new standards in Ocean Cruising:

STATEROOM FEATURES

- Handsome burlled wood surfaces
- Fully air-conditioned with individual comfort regulator
- Italian marble bathroom with shower (bathtub & shower in suites)
- Color television and radio
- Minibar
- Turndown Service
- Hair dryer
- Bathroom outlet (110/230v, 60 Hz)
- European style duvets and pillows
- Luxurious Terry Bathrobes
- Slippers
- Safe Deposit Box
- Telephone (internal and satellite)
- Limited 24 Hour Room Service
- Sewing Kit / Shoe Horn
- Umbrella / Duffle Bag
- Writing Paper / Postcards

RESTAURANT FEATURES

- Berlin Restaurant - main dining room
- Chancellor's Suite - private dining room
- Four Season's Restaurant - formal dining room (no charge)
- Lido Cafe and Grill - casual dining room
- Course by Course Silver Service
- Up to Nine Course Evening Meals
- Complimentary Coffee and Tea included

SHIP FEATURES

- Classic Appointments
- Emperor's Ballroom
- 3 Restaurants
- 2 Lounges / 7 Bars
- Original Works of Art
- 24 Hour Reception
- Infirmary with Qualified Doctor on Every Voyage
- Boutique / Gift Shop
- Hairdressing Salon
- Concierge
- E-Mail Access
- Library
- Laundry / Dry Cleaning
- Photo Service
- Shore Excursion Office
- Indoor / Outdoor Pool
- Wellness Spa
- Gym / Fitness Coaches
- Finnish Sauna / Roman Steam Bath
- Sun Deck / Pool Bar
- Cinema / Conference Room
- Elevators
- Golf Deck
- Zodiacs
- Children's Room / Babysitting
- Nightly Entertainment
- Multilingual Crew
- One Staff Member for every two passengers
- No Smoking except Open Decks and Old Fritz Pub



MS Deutschland Deck Plans

Deck 9 LIDO DECK

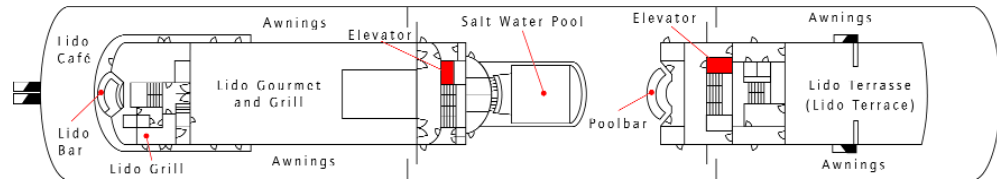

Deck 8 ADMIRAL DECK Cabins No. 8001 to 8042 (outside) Cabins No. 8101 to 8112 (inside)

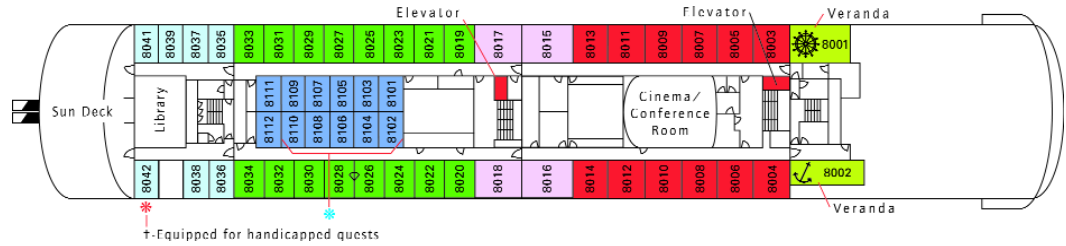

Deck 7 COMMODORE DECK Cabins No. 7001 to 7016 (outside)

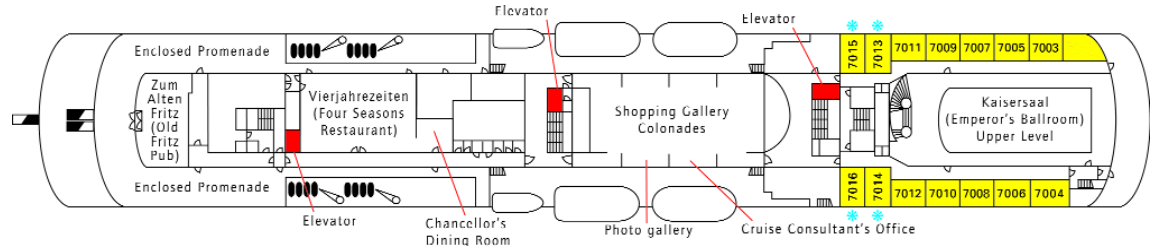

Deck 6 DEUTSCHLAND DECK

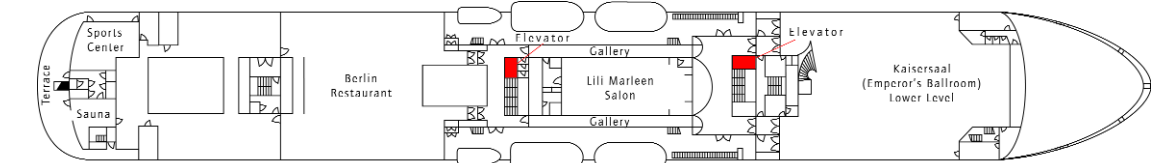

Deck 5 CAPTAIN'S DECK Cabins No. 5001 to 5082 (outside) Cabins No. 5101 to 5108 (inside)

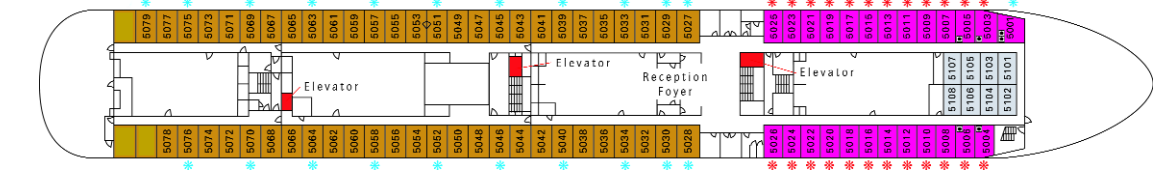

Deck 4 STUEMANN'S DECK (Quartermaster's Deck) Cabins No. 4001 to 4086 (outside) Cabins No. 4101 to 4154 (inside)

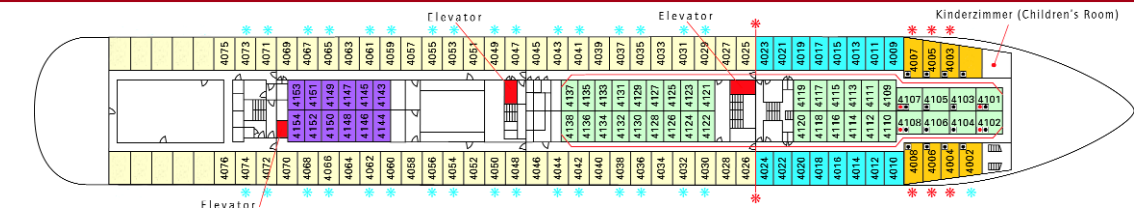

Deck 3 KUR DECK (Deutschland Wellness Spa)

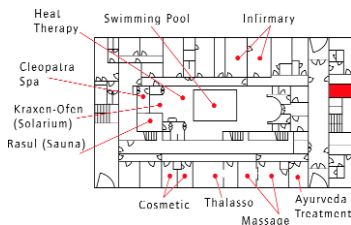

Deck 10 GOLF DECK

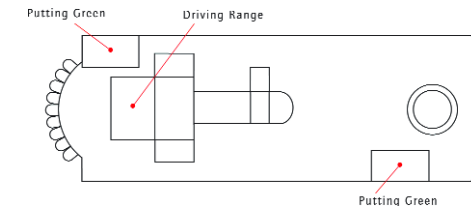

MS Deutschland Specifications

Maiden Voyage:	May 1998
Gross Tonnage:	22,400
Dimensions:	Length: 574 ft./175m Width: 82 ft./25m Draft: 18ft. 4 inch/5.6m
Country of Registry:	Germany
Passengers:	520 maximum
Staff: International:	280
Officers:	German

Category	Cabin	Deck	Category	Cabin	Deck
A	Twin Inside	4	I	Twin Outside	7
B	Single Inside	4	K	Twin Inside	8
C	Twin Outside	4	M	Twin Outside	8
D	Single Outside	4	N	Twin Outside	8
E	Twin Outside	4	O	Twin Outside	8
F	Single Inside	5	P	Twin Outside	8
G	Twin Outside	5		Executive Suite	8
H	Twin Outside	5		Owner's Suite	8

Notes

- Available as Triple
- Available as Quad

- Cabin with one twin bed and one sofa bed

- Double cabin with twin beds

Cabin 8042 is suitable for a wheelchair.

All unmarked cabins have one Queen size bed.

All inside cabins have separate twin size beds.

Cabins 5051 and 5053, and 8026 and 8028, have interconnecting doors.